





**URA / CUD PLAN
RELEASE 7/2008E**

**STREETBLOCK PLAN FOR
BEACH ROAD, NORTH BRIDGE
ROAD, MIDDLE ROAD AND
SEAH STREET
(DOWNTOWN CORE
PLANNING AREA)**

**SITE PLAN /
BUILDING HEIGHT PLAN**

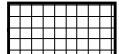
LEGEND

-  Boundary for Streetblock Plan
-  Line of Road Reserve
-  Maximum Building Height 6 Storeys
-  Maximum Building Height 5 Storeys
-  House Nos.

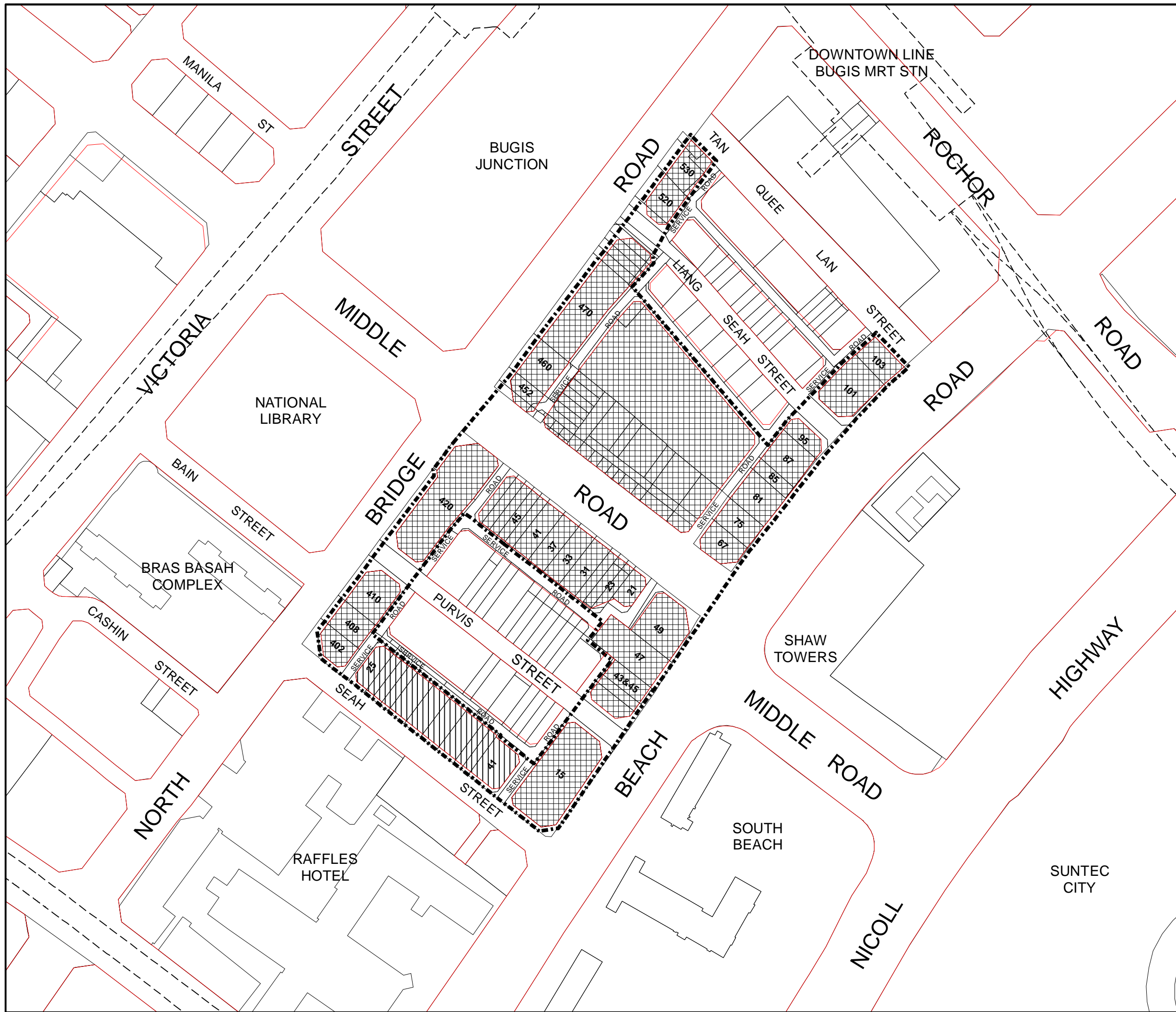

SCALE : 1:2000



DRWG NO : DT/2008/001

DATE : NOV 2008

DIVISION : C & UD



To make Singapore a great city to live, work and play in