

# TIONG BAHRU

-  BOUNDARY OF GAZETTED CONSERVATION AREA
-  CONSERVED BUILDINGS \*

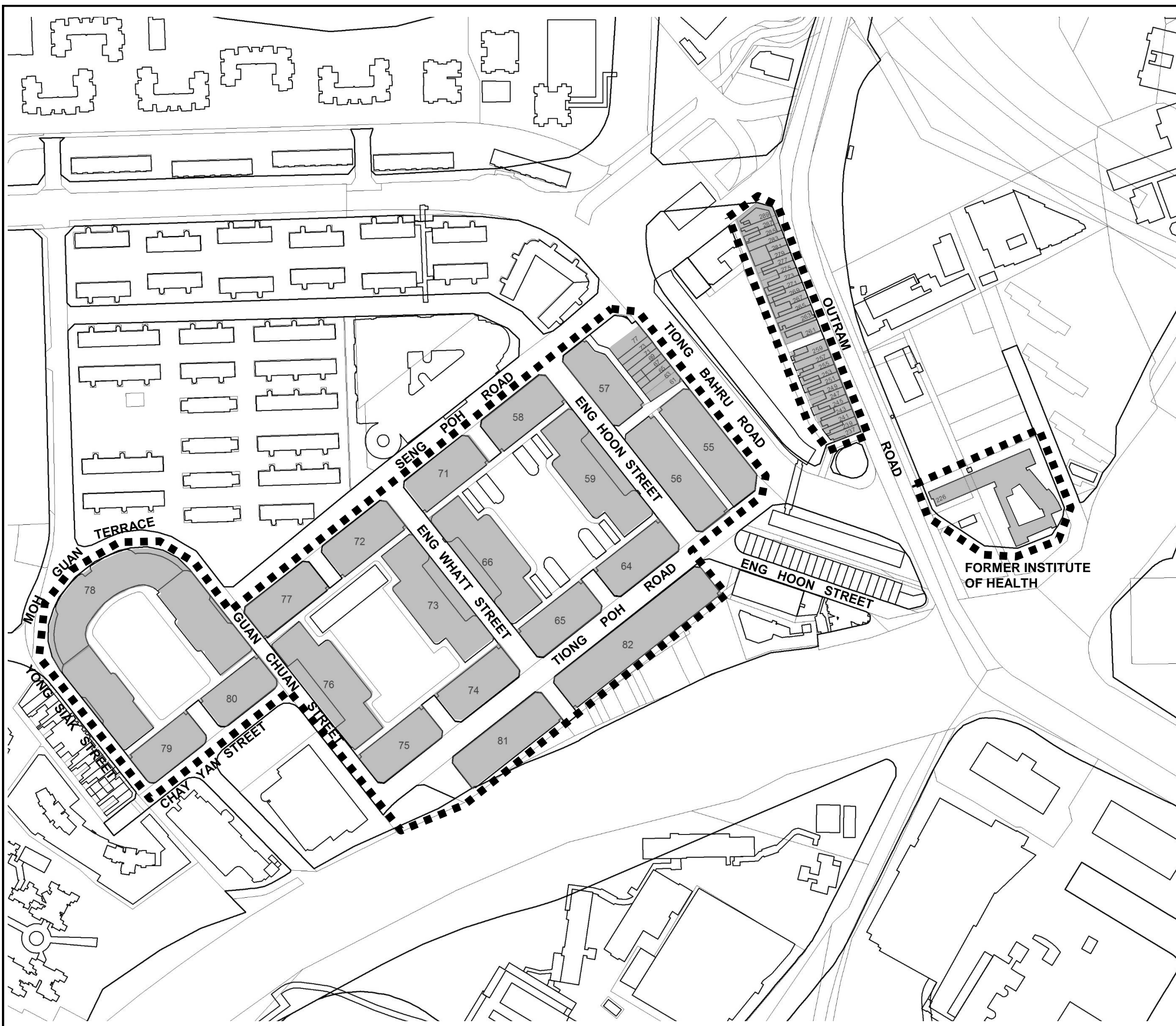

### RESIDENTIAL FRONT

\* All buildings with residential front which is existing and/or identified in the specific façade restoration guidelines, regardless of land use zoning, shall be retained and restored.

DRAWING TITLE :

## CONSERVATION PLAN

SCALE : 1 : 2500

0 M  100 M

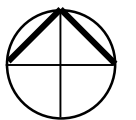

DRWG NO :

DATE : NOVEMBER 2017

CONSERVATION DEPARTMENT



URBAN  
REDEVELOPMENT  
AUTHORITY

To make Singapore a great city to live, work and play