

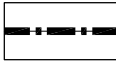



# DEVELOPMENT AT KAMPONG JAVA

## LAND PARCEL

SITE AREA : 11,643.3 m<sup>2</sup>  
(Subject to Cadastral Survey)

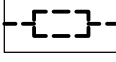
## LOCATION PLAN

-  SALES PARCEL
-  Amenities
-  Existing MRT Station and Rapid Transit System alignment (Location & profile indicative only)
-  Drainage Reserve
-  Future Open Space

SCALE: 1 : 5000  
0 50 100 150 200m



**UR** URBAN  
REDEVELOPMENT  
AUTHORITY

To make Singapore a great city to live, work and play

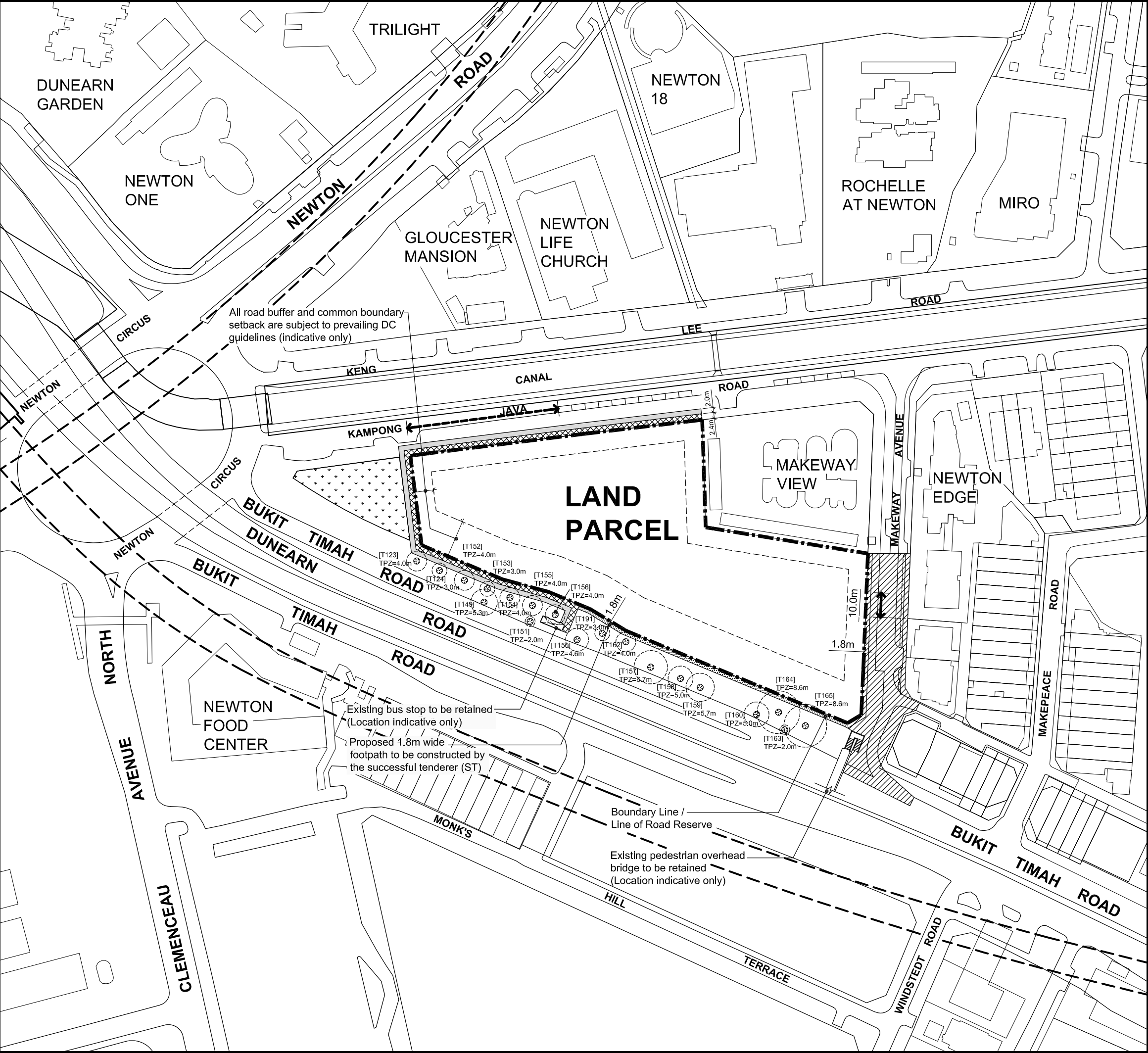

# DEVELOPMENT AT KAMPONG JAVA ROAD

## LAND PARCEL

SITE AREA : 11,643.3 m<sup>2</sup>  
(Subject to Cadastral Survey)

## CONTROL PLAN

- Boundary Line
- Proposed vehicular ingress / egress
- Temporary construction access is allowed along this stretch of road
- Future Open Space
- Proposed road widening works to be carried out by the successful tenderer (Indicative only)
- Proposed 1.8m wide footpath to be constructed by the successful tenderer (Indicative only)
- Proposed 2.4m wide covered linkway to be constructed by the successful tenderer (Indicative only)
- Proposed 2.0m wide cycling path to be constructed by the successful tenderer (Indicative only)
- Existing trees to be retained (Location indicative only)

## NOTES :

The Control Plan of the proposed development is intended as a guide on the requirements of the Urban Redevelopment Authority.

The successful tenderer shall confirm and comply with the requirements of the relevant Competent Authorities before submission of plans for formal consideration.

The Control Plan is to be read in conjunction with the Conditions of Tender and Technical Conditions of Tender.

All site areas are estimated and location of existing structures are indicative only and are subject to final survey.

SCALE : 1:1500  
0 15 30 45 60 m



**UR** URBAN  
REDEVELOPMENT  
AUTHORITY

To make Singapore a great city to live, work and play